

Type B Installation Guide:

1. DISCONNECT POWER TO LUMINAIRE

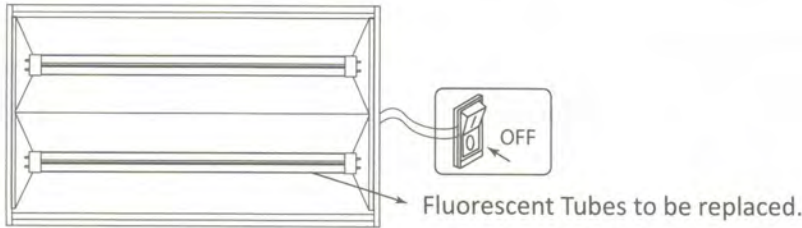

Disconnect power to luminaire or circuit(if possible). Ensure all power is OFF by using a voltmeter or other approved method to confirm.

2. REMOVE EXISTING TUBE LAMP(S)

- Remove troffer lens, if present.
- Remove existing fluorescent tube by rotating one-quarter turn and sliding lamp(s)
- Remove ballast cover.(Cover may be secured with screws or tabs).

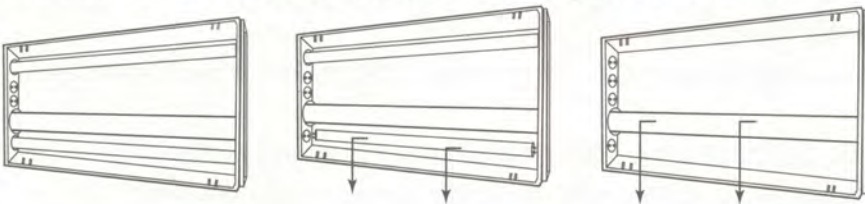

3. RETROFIT LUMINAIRE

Please rewiring the circuit according to the following circuit diagram

Case 1: Direct AC wiring diagram without dimming

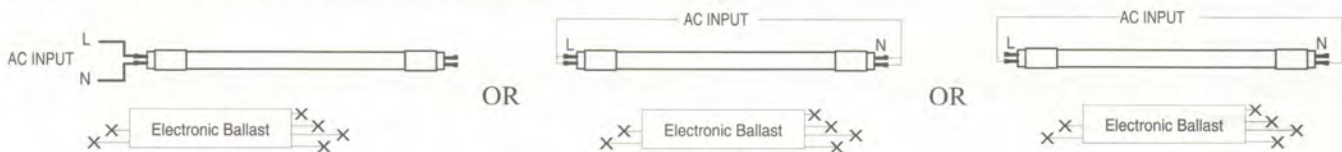

Voltage Input: AC120-277V 50/60Hz

Case 2: Direct AC wiring diagram with 0-10V dimming system

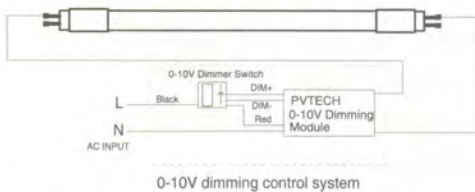

Voltage Input: AC120-277V 50/60Hz

4. INSERT LED TUBES

- Ensure both the ends of the LED tube are aligned with socket, then insert LED lamp in the normal way by sliding pins into sockets and rotating a quarter turn until the LED tube locks in place.
- LED lamps are now fully installed.
- Replace troffer lens, if present.
- After modification completed. Attach the replacement marking and cautionary label to a visible place on the luminaire and keep it visible after installation.

5. RESTORE THE POWER OF LUMINAIRE

Restore power to circuit/luminaire and test light. If necessary, adjust position of LED tube, and enjoy your new LED tube!

T5 LED Tube Installation Guide

LED Linear T5-Direct (Type B)

Please keep this Quick Installation Guide for future reference.
Modifications to the product void the Warranty.
Suitable to replace fluorescent lamps as specified on the product label.

WARNING :

TYPE B Application (DIRECT WIRE,Ballast-Free)

To avoid personal injury and/or possible product damage, the following cautions must be followed:

- Read all safety information and instructions before installation.
- RISK OF ELECTRIC SHOCK. Disconnect power at fuse or circuit breaker before installing or servicing.
- CAUTION - RISK OF FIRE. DO NOT USE WITH BALLAST.
- Suitable for damp locations - Not for use where directly exposed to water.
- Caution: Do not use with dimmers.
- This device is not intended for use with emergency exits.
- To prevent early lamp failure, lamp should only be installed in operating environments ranging between: -20°C and +45°C (-4°F and +113°F).
- WARNING – RISK OF FIRE OR ELECTRIC SHOCK. LED Retrofit Kit installation requires knowledge of luminaires electrical systems. If not qualified, do not attempt installation. Contact a qualified electrician.
- WARNING – RISK OF FIRE OR ELECTRIC SHOCK. Install this kit only in the luminaires that have the construction features and dimensions shown in the photographs and/or drawings and where the input rating of the retrofit kit does not exceed the input rating of the luminaire.
- Do not make or alter any open holes in an enclosure of wiring or electrical components during kit installation.
- WARNING - To prevent wiring damage or abrasion, do not expose wiring to edges of sheet metal or other sharp objects.
- Installers should not disconnect existing wires from lamp socket terminals to make new connections at lamp socket terminals. Instead, installer should cut existing lamp socket leads away from the lamp socket and make new electrical connections to lamp socket lead wires by employing connectors suitable for the application.
- THIS RETROFIT KIT IS ACCEPTED AS A COMPONENT OF A LUMINAIRE WHERE THE SUITABILITY OF THE COMBINATION SHALL BE DETERMINED BY AUTHORITIES HAVING JURISDICTION. PRODUCT MUST BE INSTALLED BY A QUALIFIED ELECTRICIAN IN ACCORDANCE WITH THE APPLICABLE AND APPROPRIATE ELECTRICAL CODES. THE INSTALLATION GUIDE DOES NOT SUPERSEDE LOCAL OR NATIONAL REGULATIONS FOR ELECTRICAL INSTALLATIONS.
- Examine all parts that are not intended to be replaced by the retrofit kit for damage and replace any damaged parts prior to installation of the retrofit kit.
- The tube is installed as Type B, the luminaire, once modified as retrofit fixture, will no longer operate fluorescent lamps.
- For a linear tubular LED lamp conversion, there shall be text or a diagram showing how the supply connections were made to the lamp holders so the correct connections will be made to the lamp when the lamp is installed or replaced.