

LED RGBW COLOR SMART BULBS

- A19, BR30 and PAR30

QUICK START GUIDE



Scan QR Code to download MW Smart App directly.



APP INSTALLATION

Download the MW Smart App to your smart mobile device by scanning the QR Code. The MW Smart App is available in both App Store and Google Play Store, and it's free to use for your MW Lighting products.

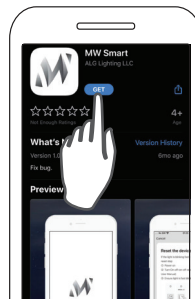
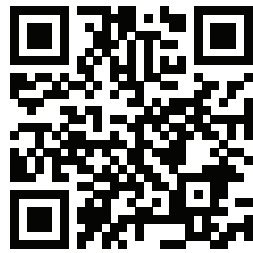

App Store

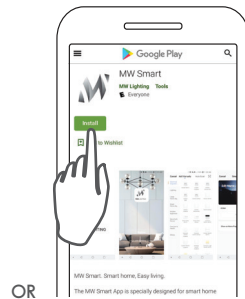

Google Play Store

2

CREATE YOUR ACCOUNT

Open the downloaded MW Smart App



Enter your email or phone number to register a user account.



Enter the verification code you received over your email or text message. You can login to your MW Smart account after setup the password.



3

WI-FI CONNECTION

Screw the light bulb in to the E26 socket. Light will flash after you turn on the power, indicating the downlight is ready for WI-FI connection.

To reset the light bulb, turn on the light and then turn it off after 1 second. the light will flash after you repeat the action 3 times, indicating the light has been reset.

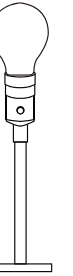
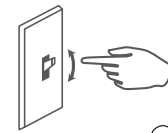

Go to WI-FI settings of your smart phone and make sure it's connected to 2.4GHz WI-FI network* if you are using a dual band router.

* This smart light works with 2.4GHz WI-FI network only.

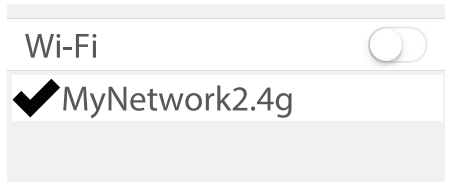

4

WI-FI CONNECTION

Open MW Smart App and select [Add Device].



Select [Lighting (Wi-Fi)] under Lighting category.

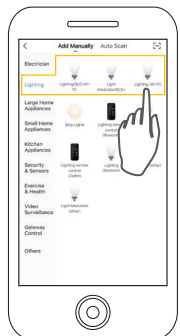

5

WI-FI CONNECTION

Confirm the smart light is blinking rapidly then enter your WI-FI network and password.

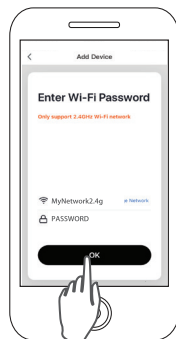
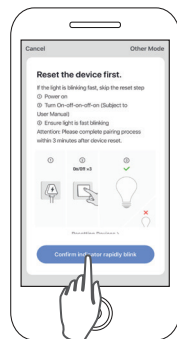

The smart light can be control via MW Smart App once the connection is established.

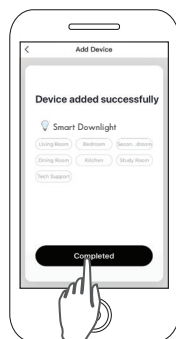
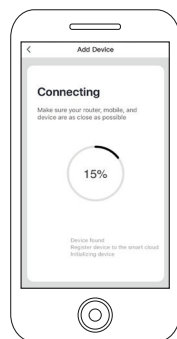

6

USING MW SMART APP

Select the device to access the control panel

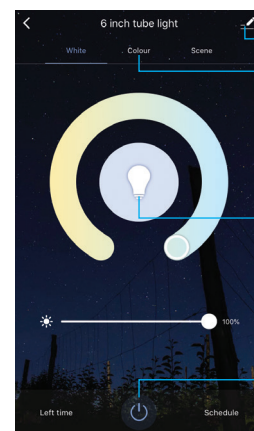
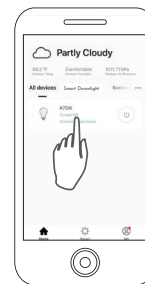

more settings options
 change the color of your light

turn your light on / off

program the timer
 automatically operate your smart light.

7

USING MW SMART APP

Select the matching icon in [More] settings menu and follow the directions to setup Amazon Alexa or Google Assistant.

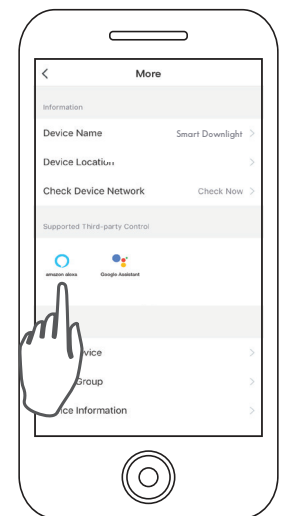

* Application may appear differently with your app as frequent updates and improvements are being made to the software.

8