

# INSTALLATION INSTRUCTIONS

MRDAJ610-5CCT DX-26519ALED10DL6WDIM9009XXUS



## Installation

**STEP 1.** Make sure the power is turned off at the source to the recessed housing(s) that you are installing the fixture(s) in. Remove existing trim and CFL, or Incandescent bulbs.

**STEP 2a.** Unscrew the screws on socket bracket, push bracket upward to the top location. (Fig. 1a)

**STEP 2b.** Remove existing socket mounting plate from the recessed housing and then remove lamp socket from the plate. (Fig. 1b)

**STEP 3.** Screw E26 base adapter into socket in recessed housing. (Fig. 2)

**STEP 4.** Select desired CCT. (Fig. 3)

**STEP 5.** Plug E26 base cable connector into the LED Recessed Kit. Make sure the kit is grounded. (Fig. 4)

**STEP 6.** Squeeze torsion springs together as shown and install into torsion spring brackets inside recessed housing. For proper installation, the torsion springs should be seated within the brackets and on both sides of the housing. (Fig. 5)

**STEP 7.** Carefully route wires into fixture and push Recessed Kit up flush to ceiling surface. Push the edge of the bezel to tilt lens up to 30°. Rotate lens assembly horizontally towards the surface to be illuminated. (Fig. 6)

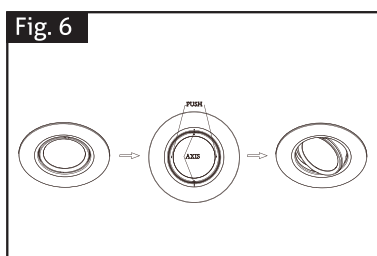
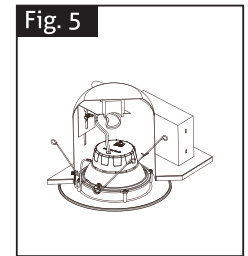
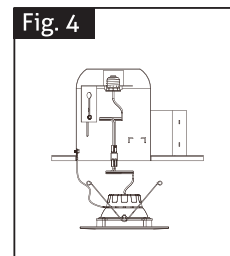
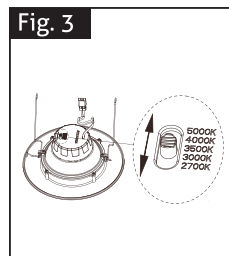
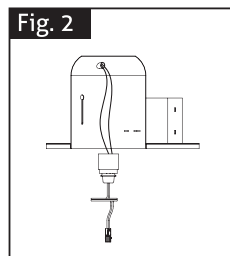
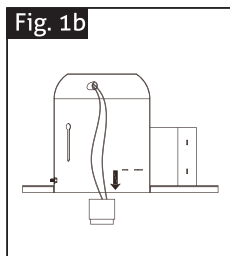
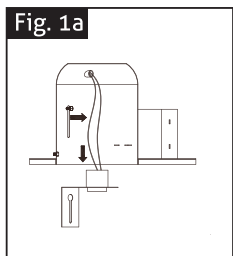

## Fixture Dimensions

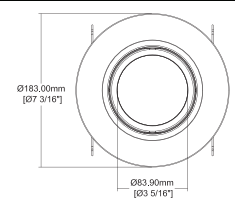
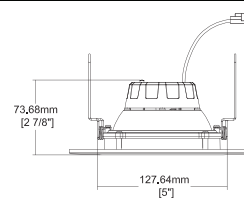
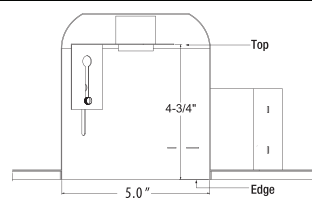

## WARNINGS:

- Risk of electrical shock. Disconnect power at fuse or circuit breaker before installing or servicing.
- To prevent early lamp failure, lamp should only be installed in operating environments ranging between  $-20^{\circ}\text{C}$  and  $+40^{\circ}\text{C}$  ( $-4^{\circ}\text{F}$  and  $+104^{\circ}\text{F}$ ).
- No user serviceable parts inside. To avoid electrical shock do not disassemble product.
- Risk of fire or electric shock, LED Retrofit Kit installation requires knowledge of luminaires electrical systems. If not qualified, do not attempt installation. Contact a qualified electrician.
- Risk of fire or electric shock, Install this kit only in luminaires that have the construction features and min dimensions shown in the Figure 1 and where the input rating of the retrofit kit does not exceed the input rating of the luminaire.
- Do not make or alter any open holes in an enclosure of wiring or electrical components during kit installation
- To prevent wiring damage or abrasion, do not expose wiring to edges of sheet metal or other sharp objects.
- Installers should not disconnect existing wires from lampholder terminals to make new connections at lampholder terminals, Instead installers should cut existing lampholder leads away from the lampholder and make new electrical connections to lampholder lead wires by employing applicable connectors.
- This retrofit kit is accepted as a component of a luminaire where the suitability of the combination shall be determined by authorities having jurisdiction.
- This device is not intended for use with emergency exits.
- This retrofit kits suitable for wet locations luminaires specified as below: Type Non IC; Type IC; Covered ceiling; Uncovered ceiling. Installers should examine all parts that are not intended to be replaced by the retrofit kit for damage and replace any damaged parts prior to installation of the retrofit kit.

NOTE 1: This equipment has been tested and found to comply with the limits for a Class B digital device, pursuant to part 15 of the FCC Rules. These limits are designed to provide reasonable protection against harmful interference in a residential installation. This equipment generates, uses and can radiate radio frequency energy and, if not installed and used in accordance with the instructions, may cause harmful interference to radio communications. However, there is no guarantee that interference will not occur in a particular installation. If this equipment does cause harmful interference to radio or television reception, which can be determined by turning the equipment off and on, the user is encouraged to try to correct the interference by one or more of the following measures:

- Reorient or relocate the receiving antenna.
- Increase the separation between the equipment and receiver.
- Connect the equipment into an outlet on a circuit different from that to which the receiver is connected.
- Consult the dealer or an experienced radio/TV technician for help.

NOTE 2: Any changes or modifications to this unit not expressly approved by the party responsible for compliance could void the user's authority to operate the equipment